

2012

# Cemetery Plan of Management



## Preface

Goulburn Mulwaree Council has prepared this plan of management for the Cemeteries managed by Council.

Enquiries should be addressed to:

The General Manager

Goulburn Mulwaree Council

Locked Bag 22

Goulburn NSW 2580

Telephone: (02) 4823 4444

Email: [council@goulburn.nsw.gov.au](mailto:council@goulburn.nsw.gov.au)

This document is available on the Council's website [www.goulburn.nsw.gov.au](http://www.goulburn.nsw.gov.au)

List of relevant dates and amendments:

Version	Council Meeting Date	Resolution	Adoption Date	Effective From
1	15 May 2012	12/164	3 June 2012	3 June 2012
<b>All policies can be reviewed or revoked by resolution of Council at anytime.</b>				

## Table of Contents

Preface.....	2
Table of Contents .....	3
Cemetery Plan of Management.....	5
1.1 Scope .....	5
1.2 Local Government Area (LGA) .....	5
1.3 Cemeteries within the Local Government Area .....	6
1.4 History .....	7
1.5 Capacity .....	8
1.6 Value and Function for the Community .....	8
1.7 Future Use & Development of Council Cemeteries .....	9
1.8 General Action Plan .....	10
1.9 Site Specific Action Plan.....	13
1.10 Maintenance.....	15
1.11 Naming Procedures .....	16
Appendix One – Goulburn General Cemetery.....	17
A1.1 Location .....	17
A1.2 History .....	18
A1.3 Status .....	19
A1.4 Current Layout.....	19
A1.5 Capacity .....	21
A1.6 Future Memorialisation .....	21
A1.7 General Cemetery Action Plan .....	28
Appendix Two – Kenmore Cemetery .....	31
A2.1 Location .....	31
A2.2 History .....	31
A2.3 Status.....	32
A2.4 Current Layout .....	32
A2.5 Capacity .....	34
A2.6 Future Memorialisation .....	34
2.7 Kenmore Cemetery Action Plan .....	36
Appendix Three – Tarago Cemetery.....	39
A3.1 Location .....	39
A3.2 History .....	40
A3.3 Status.....	40
A3.4 Current Layout .....	40

A5.5 Capacity .....	42
A5.6 Action Plan .....	43
Appendix Four – Tallong Cemetery .....	44
A4.1 Location .....	44
A4.2 History .....	45
A4.3 Status.....	46
A4.4 Current Layout .....	46
A4.5 Capacity .....	47
A4.7 General Action Plan.....	48
Appendix Five – Jewish Cemetery .....	49
A5.1 Location .....	49
A5.2 History .....	50
A5.3 Status.....	51
A5.4 Current Layout .....	52
A5.5 Capacity .....	54
A5.6 Jewish Cemetery Action Plan .....	54
Appendix Six – Mortis Street Cemetery.....	55
A6.1 Location .....	55
A6.2 History .....	56
A6.3 Status.....	58
A6.4 Current Layout .....	58
A6.5 General Action Plan.....	59
Appendix Seven – Other Cemeteries.....	60

# Cemetery Plan of Management

---

## 1.1 Scope

The purpose of this Plan of Management (POM) is to form the basis for the management of the cemeteries under the control of the Goulburn Mulwaree Council. It is noted that there are in excess of 40 cemeteries in the LGA, the majority of which are privately maintained. Refer to Appendix 8 for a list of cemeteries, not comprehensive.

It is designed to set out the objectives and long term management strategies for the sites. This POM has been based on previous adopted Plans and carries over primary strategies identified in those plans.

The purpose of the Plan is to:

- Develop an overall plan for the ongoing management of the cemeteries.
- Ensure future development of each site respects the heritage significance of the existing cemeteries covered by this document.
- Address changing attitudes to interments by providing a broader range of options to suit an individual or families' needs.
- Provide effective options of memorialisation that best represents the community located within the Goulburn Mulwaree Council Local Government Area.

The following cemeteries will be covered within the Plan:

1. Active Cemeteries
  - General Cemetery – Appendix 1
  - Kenmore Cemetery – Appendix 2
  - Tarago Cemetery – Appendix 3
  - Tallong Cemetery – Appendix 4
2. Inactive Cemeteries
  - Jewish Cemetery – Appendix 5
  - Mortis Street Cemetery – Appendix 6

## 1.2 Local Government Area (LGA)

The Goulburn Mulwaree Council is located in the Southern Tablelands of New South Wales, some 200km's from Sydney (to the North East) and 95km's from Canberra (to the South). Figure 1 below outlines the Local Government Area for the Goulburn

Mulwaree Council. The Council covers an area of 3,232 km<sup>2</sup> and has a population of approximately 27,112 people. Approximately 15.7% of the population is over the age of 65 years (www.abs.gov.au).

The centre of population is Goulburn, with villages at Marulan, Tarago, Lake Bathurst, Tallong, Towrang and Bungonia. Urban areas account for 77.1% of the population with the remaining population located in other locations within the Local Government Area.

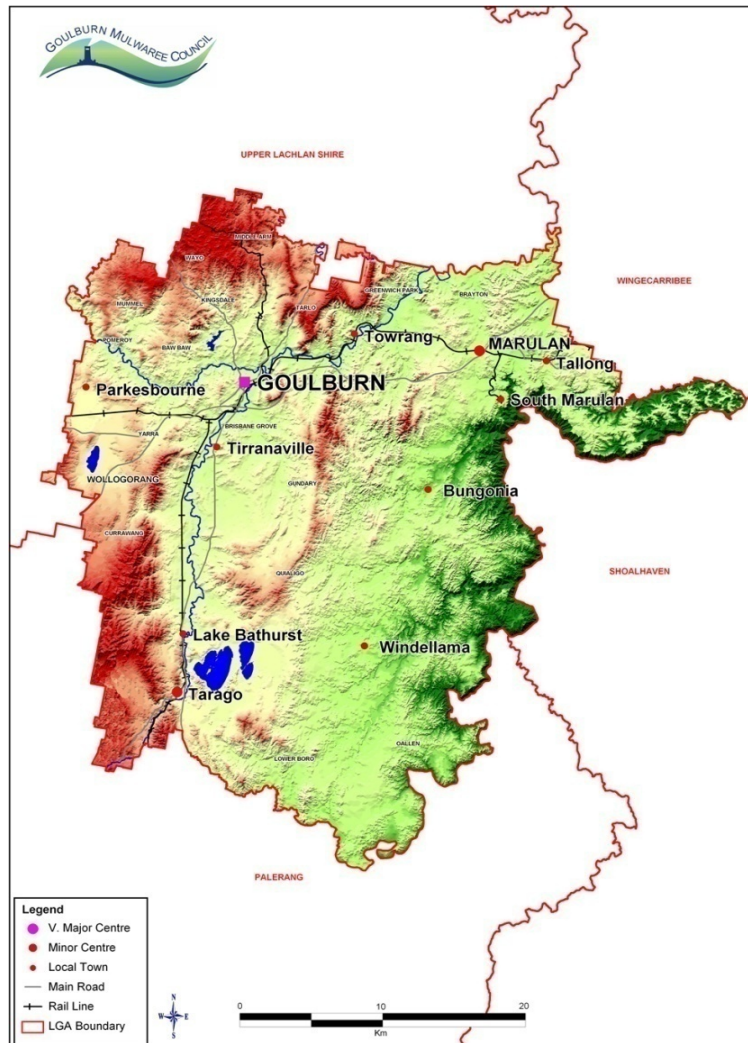

Figure 1 (Goulburn Mulwaree Council Management Plan 2010/11)

### 1.3 Cemeteries within the Local Government Area

There are in excess of forty cemeteries located within the Goulburn Mulwaree Council LGA. Of these, seven are managed by the Goulburn Mulwaree Council, as follows:

Active:

- General Cemetery;
- Kenmore Cemetery (also known as Catholic or St. Patrick's Cemetery);
- Tarago Cemetery; and
- Tallong Cemetery

Inactive:

- Kenmore Hospital Cemetery;
- Jewish Cemetery; and
- Mortis Street Cemetery.

A list of other cemeteries located within the Goulburn Mulwaree Council LGA can be found in Appendix 7.

## 1.4 History

The first cemetery established in Goulburn was the Church of England burial ground known as St. Saviours', named for the Anglican parish. This cemetery was in use from about 1830 until 1937, and is situated adjacent to the Goulburn Gaol on the north-eastern edge of the city.

Nearby lies the second oldest cemetery, the General Cemetery now known as the Mortis Street Cemetery, established in the late 1830's. It was probably set aside for the purpose shortly after the establishment of the site for the St. Saviour's Cemetery. It lies south of the Gaol, off Cemetery Street. It has sections for burials of Presbyterian, Roman Catholic, Methodist and possibly Baptist adherents. This cemetery was in use until about 1900, when the new General Cemetery on the slope of Governor's Hill was dedicated; however, some burials occurred after 1900 with one monument bearing a date as recent as 1954. The earliest Roman Catholic burials took place in the Mortis Street Cemetery. Many interesting monuments commemorating early pioneers and settlers in Goulburn, including Roman Catholics are therefore located in the Mortis Street burial ground.

There had always been a strong Catholic presence in Goulburn and the surrounding district. In 1858, for instance of a population numbering 7028 in the electorates of Argyle and Goulburn, 2622 were Roman Catholics, out numbered by Church of England adherents by only 504.

In the 1870's the Roman Catholic diocese of Goulburn flourished under the leadership of the Very Rev. Dr. Michael McAlroy, in whose time eleven churches were built, together with a convent. Another period of expansion occurred in the 1920's and 1930's which saw the establishment of further schools, a hospital, a

technical school and novitiates. St. Patrick’s College was built in 1874 and with the cemetery located on Middle Arm Road sharing the name of that Christian Brother’s School. That Cemetery is notable for the large number of religious burials in the special areas set aside for this purpose. The number of such memorials reflects the importance of Goulburn as a diocesan centre with responsibilities for religious training as well as education of the lay population.

In April 1998 the Catholic Church transferred ownership of the cemetery to the former Goulburn City Council (now Goulburn Mulwaree Council) for ongoing management and operation. The Church retained ownership of the Chapel and the immediate surrounding burial ground area. Council renamed the cemetery to Kenmore Cemetery to reflect the change in ownership and its operation as a non-denominational burial-ground.

### 1.5 Capacity

Current consumption of graves indicates Council’s current facilities will last approximately 45 years, assuming the proportions of lawn interments and ashes interments remaining constant. The development of alternate options of interment, most particularly an increase in the availability of desirable options for the interment of ashes, will greatly increase the life expectancy of the Council managed cemeteries.

The table below highlights the current usage and availability of cemetery plots within the cemeteries:

Cemetery	Estimated number of surveyed sites	Estimates number of surveyed sites reserved	Estimated number of unsurveyed sites	Average annual consumption of sites	Available Sites
General Cemetery	4200	2000	0	150	
Kenmore Cemetery	2300	1500	6000	20	
Tallong	200	50	880	1	50
Tarago	560	128	0	1	430

### 1.6 Value and Function for the Community

The cemeteries provide an important service for the community. Table 1 – Current Uses of Council Operated Cemeteries below outlines the primary and secondary uses of the cemeteries operated by the Council.



Type of Use	Description
<b>Primary Use</b>	Burials in-ground.  Interment of ashes in existing coffin. Interment allotments. Especially created memorial gardens or walls.  Visitation of graves and memorials, or the cemetery, to pay respects or reflection.  Inquiries concerning funerals, burials, ash interments, purchase of pre-need and at-need sales.
<b>Other Key Uses</b>	Research by genealogists, historians and individuals.  Educational purposes, for example schools.  Passive recreation.  Historical reflection, particularly ANZAC Day.

Table 1 – Current Uses of Council Cemeteries.

### 1.7 Future Use & Development of Council Cemeteries

A plan of management must describe the future purposes for the which the land, buildings and improvements will be permitted to be used, the scale and intensity of any such use or development and the purposes for which any further development of the land will be permitted as outlined in the following table (Table 3 – Future Use & Development of Council Cemeteries). Table 3 is only a snapshot of all the cemeteries, for more detailed information on future use and development of a specific cemetery refer to the relevant appendix.

Purpose of Future Use	Scale and Intensity of Future Use	Purpose of Future Development
<b>Primarily as an operational cemetery including for in-ground burials, ashes interments, graves visitation and</b>	Burials according to market forces and the availability of plots/spaces.	Possibly develop more locations for ashes interments as required to address increased availability to a

<b>memorial services. Disposal of the dead.</b>	Increased sale of ashes memorials desirable but contingent on business feasibility.	crematorium and greater variations for memorialisation.
<b>Other key uses may include research and education, and cultural tours and special events.</b>	Increased research and education through greater access to web based information, cultural tours, and event usage where feasible.	Further develop records and availability of plots/niches for greater access through the web.

## 1.8 General Action Plan

This section outlines the issues concerning the future management of all or parts common to all Council owned cemeteries. It provides a guide to what projects might be considered and undertaken to address these issues. Issues relating to specific cemeteries can be found in the appendices addressing each individual cemetery.

Table 4 – Issues common to all cemeteries, below, outline the key issues common to all cemeteries, explain the nature of the issues and provide a response to the issue. In some instances photographs are provided in Appendix 9.

<b>Issue</b>	<b>Explanation</b>	<b>Possible Response</b>
<b>Signage</b>	Existing signage is not standardised, there is a lack of some signage such as informational, educational and directive ones, and some signs have deteriorated or are obtrusive.	Standardise signs, put in place new signs as appropriate, remove and replace obtrusive signs.  Refer to photograph one, below this table for a possible location sign to be adapted to each Council owned cemetery. Street signage and sectional markers could be designed using the same colour scheme and font.

<p><b>Fauna</b></p>	<p>The ongoing presence of native animals at the cemeteries needs to be encouraged.</p> <p>The presence of feral animals and vermin such as rats may be negatively impacting on the cemetery's structure vegetation and native wildlife.</p>	<p>Monitor the presence and impacts of feral animals and vermin and respond appropriately where necessary.</p>
<p><b>Flora</b></p>	<p>Weeds are a major problem in the cemetery as they cover headstones, indigenous vegetation, grave plantings, and contribute to the slow damage to built monuments.</p>	<p>Control and remove weeds. Priority areas include monuments with significant risk of failure due to weeds and boundaries to minimise the spread of weeds from surrounding lands.</p>
<p><b>Archives</b></p>	<p>Archives or records are located at both the General Cemetery and the Goulburn Mulwaree Council Civic Centre located at Bourke Street in the form of ledger books and maps. This can be cumbersome and present potential problems with accuracy and security.</p>	<p>It is proposed to investigate and further enhance an electronic record keeping system that can allow for real time access to cemetery records and management.</p> <p>The future development of allowing public access of records and cemetery maps through the web.</p> <p>Further development of record keeping through technology will aid in the identification of unused sites within the old sections all Council managed sections.</p>

<b>Ashes Interments</b>	To accommodate the potential increased demand for ashes interments from the development of a local crematorium.	Availability of a greater variety of memorialisation options for ashes interments.
<b>Lawn and Monument Interments</b>	To accommodate demand for lawn or monument burials within all active cemeteries.	To ensure that sufficient space is available for the memorialisation of deceased in both lawn and monument sections within all active cemeteries.  To identify areas for future expansion as space for this type of interment decreases.
<b>Security – Fences and gates</b>	The level of boundary security is insufficient to protect the cemetery against anti-social behaviour after dark, vandalism and destruction of memorials and landscapes, including graffiti.	Build new fences or modify existing ones to improve security as required in accordance with relevant conservation policies.
<b>Facilities</b>	The level and standard of public amenities and infrastructure is insufficient to meet visitor's needs.	To construct adequate amenities within the cemeteries to cater for visitor's needs.  To identify other facilities that meet the needs of visitors, including seats, shade areas and paths and toilets.

Table 4 – Issues Common to all Cemeteries

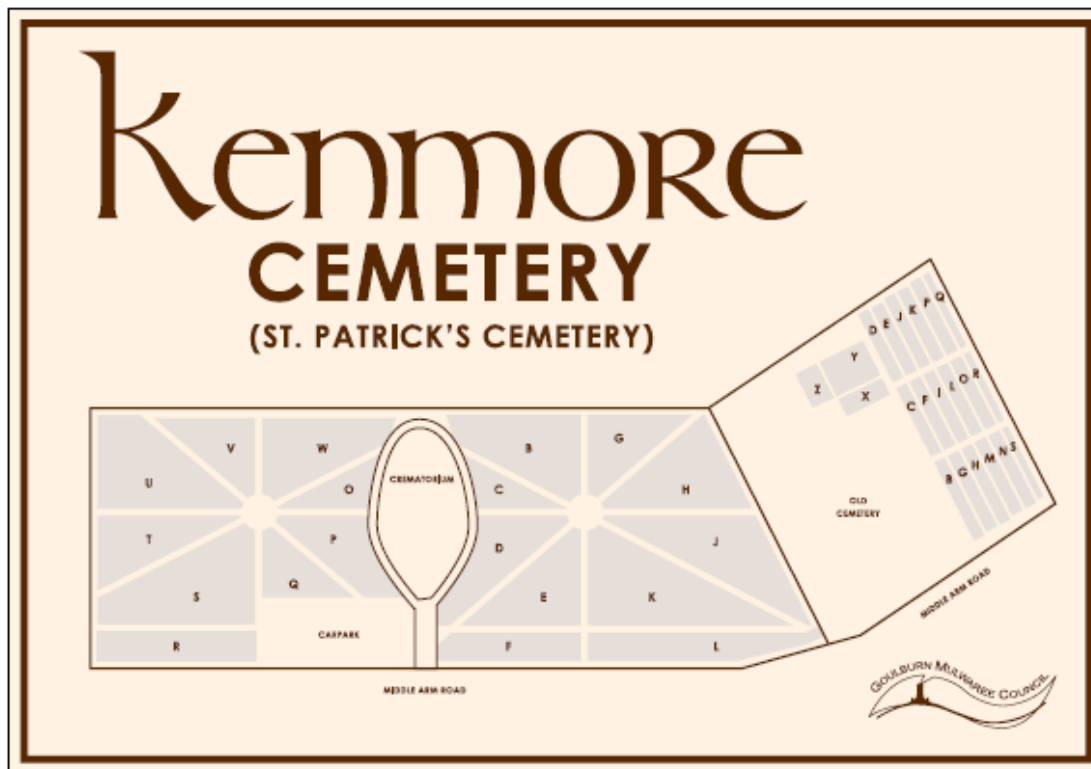

Figure 2 – Example of Proposed Signage layout

### 1.9 Site Specific Action Plan

The table below lists the high priority actions identified from the Plan of Management for each site.

Cemetery	Issue	Explanation	Possible Response
General Cemetery	Ashes Interments	To provide a greater variety of options for the interment of Ashes.  To accommodate potential increased demand for ashes interments resulting from the development of a local crematorium.	High Priority – provide options highlighted in section A1.6, with the Ashes Rose Garden being the highest priority.

Kenmore Cemetery	Ashes Interments	To provide a greater variety of options for the interment of Ashes.  To accommodate potential increased interments resulting from the development of a local crematorium.	High Priority – provide options highlighted in section A2.6.
Kenmore Cemetery	Landscaping	To improve the landscaping to allow for a more private and peaceful place for reflection and time with departed family members and friends.	High Priority – the establishment of an avenue of trees that can be utilised as a remembrance grove with spaces provided at the base of each tree for plaques.
Kenmore Cemetery	Facilities	To provide visitors' with adequate public amenities when visiting the cemetery.	The construction of a public amenity block within the cemetery grounds.

## 1.10 Maintenance

While the Plan of Management provides guidance for ongoing capital and strategic improvements at the cemeteries, to ensure that the cemetery continues as a place for remembrance of the deceased and sombre reflection the ongoing maintenance of the site is essential. The following table (Table 5 – Maintenance Schedule) details the maintenance activities and standards for the cemeteries:

Maintenance Area	Schedule
<b>Landscaping</b>	<p>Landscaped areas will be maintained within allocated budgets and to the requirements of each landscaped area.</p> <p>Plant species will be replaced in Council maintained landscaped areas with a similar or same species of plant.</p>
<b>Turf Maintenance</b>	<p>The mowing of turf areas will be undertaken as required to ensure public safety, a satisfactory appearance at all times and to accommodate significant dates.</p> <p>Maintenance activities, such as fertilising and watering will be undertaken throughout the year in line with allocated budgets.</p> <p>The filling of sunken graves will be ongoing to ensure public safety.</p> <p>Turfing of lawn areas to be undertaken within annual available budget.</p>
<b>Headstone &amp; Monuments</b>	<p>The ongoing maintenance of the headstones and monuments is the responsibility of the families.</p> <p>Council will treat both headstones and monuments as private property.</p> <p>Council may act in the interest of public safety if a monument or headstone is deemed unsafe and a risk to the public. Council will attempt to notify the estate if any work is carried out to eliminate safety concerns.</p>
<b>Beams</b>	<p>Beams will be constructed in line with demand within the lawn section of each site.</p> <p>All work to be carried out by qualified tradesman to the required standard for each site.</p>

<b>Aesthetics</b>	<ul style="list-style-type: none"> <li>a. The rubbish will be collected from the site on a weekly basis.</li> <li>b. Investigate opportunities to improve appearance of cemeteries.</li> </ul>
<b>Additional Funding &amp; Alternate Resourcing</b>	<ul style="list-style-type: none"> <li>• Investigate grants.</li> <li>• Investigate use of volunteers, community services and prisoners.</li> </ul>

### 1.11 Naming Procedures

- All ashes walls are to be named using native flora names.
- Existing roads with names will be maintained. All new roads and paths or unnamed roads and paths will be named in accordance with Council’s current Roads and Place naming policy.



# Appendix One – Goulburn General Cemetery

---

## A1.1 Location

The Goulburn General Cemetery is located on the corner of Gorman Road and the Hume Highway, Goulburn NSW 2580 (refer to Figure A1.1 – Locality, below). It consists of Lot 7017 DP 94629.

The site occupies 11.95ha of land and lies directly north of the Sydney Road on the lower slopes of Governor’s Hill and adjoins a Recreation Reserve. The surrounding land largely forms part of the Mount Grey bushland area with rural residential properties opposite.

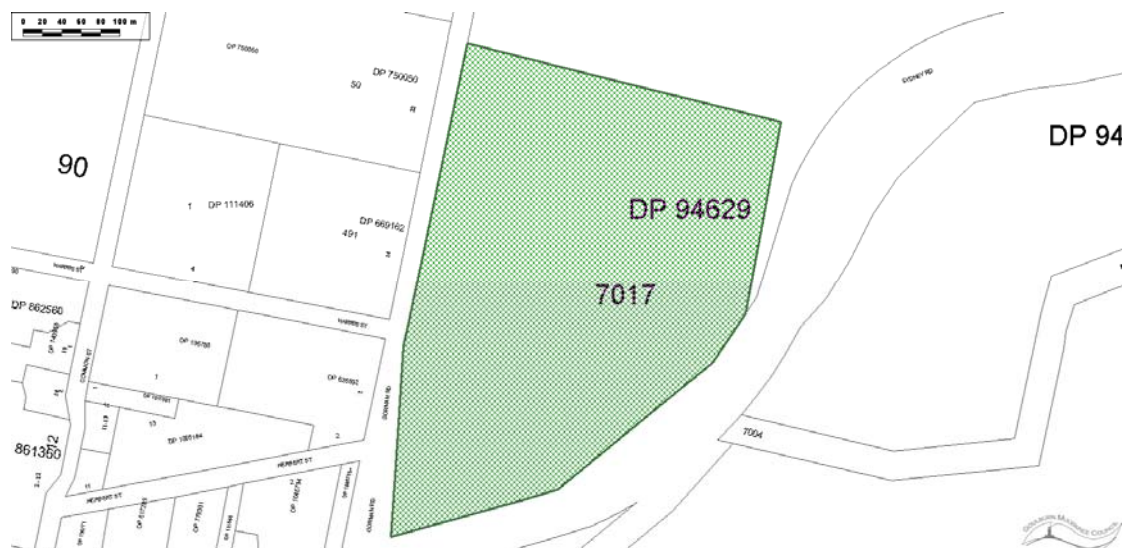

Figure A1.1 – Locality

## A1.2 History

The Goulburn General Cemetery was opened in 1903 following the closure of the Mortis Street Cemetery. The earliest burial is of a Fanny Amps, 9<sup>th</sup> September 1904 in the Church of England Section. The Goulburn General Cemetery originally had various denominational sections including:

- Church of England;
- Presbyterian;
- Methodist;
- Baptist;
- Salvation Army;
- Seventh Day Adventist; and
- Latter Day Saints.

In addition to the denominational sections there is a non-sectarian section, pauper burials, lawn sections and Soldiers Memorial area.

The site was originally designed and laid out with two major avenues which intersect at the Lychgate and large pine trees planed on its surrounds.

The Lychgate gatehouse is a federation brick structure with Gothic arch windows and wooden fretwork detailing. The Lychgate is at the head of the large Church of England section and would have acted as the main entrance. The gatehouse is not centrally located with in the Cemetery grounds.

The major avenues are named after significant local persons associated with the cemetery (refer to Figure 2 – Survey Plan; for road locations):

- Bert Gabriel Drive – local grave digger
- RJ Sidney Craig Avenue – local funeral director
- Clyde Walker Drive – Goulburn Base Hospital director, Methodist lay preacher
- Stephen Tazewell Place – local historian

The cemetery came under the care, control and management of the Goulburn City Council (now Goulburn Mulwaree Council) on the 1<sup>st</sup> October 1967 under the Local Government (Control of Cemeteries) Amendment Act 1966, having previously been under the control of six trusts.

The site, as a whole, is of local and regional significance, whilst some individual elements may possibly be of state significance. The interplay and overlap between these elements make the Goulburn General Cemetery an important cultural landscape for understanding and interpreting aspects of the evolution and development of Goulburn.

### **A1.3 Status**

The Goulburn General Cemetery is an active cemetery with spaces available for both lawn interments and ashes interments.

### **A1.4 Current Layout**

The site of the General Cemetery has been long established and is relatively isolated from the City of Goulburn. The Mount Grey Reserve and bushland area restricts expansion of the Cemetery. The vegetation now encroaches into the cemetery grounds presenting some restriction to the use of the site itself. The centrally located drainage line and historic sections of the cemetery place further constraints on the expansion of the site.

The placement of water mains, within the Cemetery grounds also limits the potential use of land for the interment of human remains.

Whilst the Goulburn General Cemetery was established at the beginning of the 20<sup>th</sup> century, the layout of the site, exhibits many of the essential features and attributes of formal 19<sup>th</sup> century garden design. The arrangement of burial areas, alignment of drives, paths, avenues of trees and axis focussing on the central Lychgate structure are considered to be the most significant elements of the Cemetery, to the extent that the original design is still evident.

The northern section of the cemetery does not exhibit to the same extent the original grid-like character of the southern portion. There is a portion of the Cemetery (at the north-east corner) containing a number of unmarked graves which is of significance. Figure A1.2 – Layout, below, illustrates the current layout of the Goulburn General Cemetery.

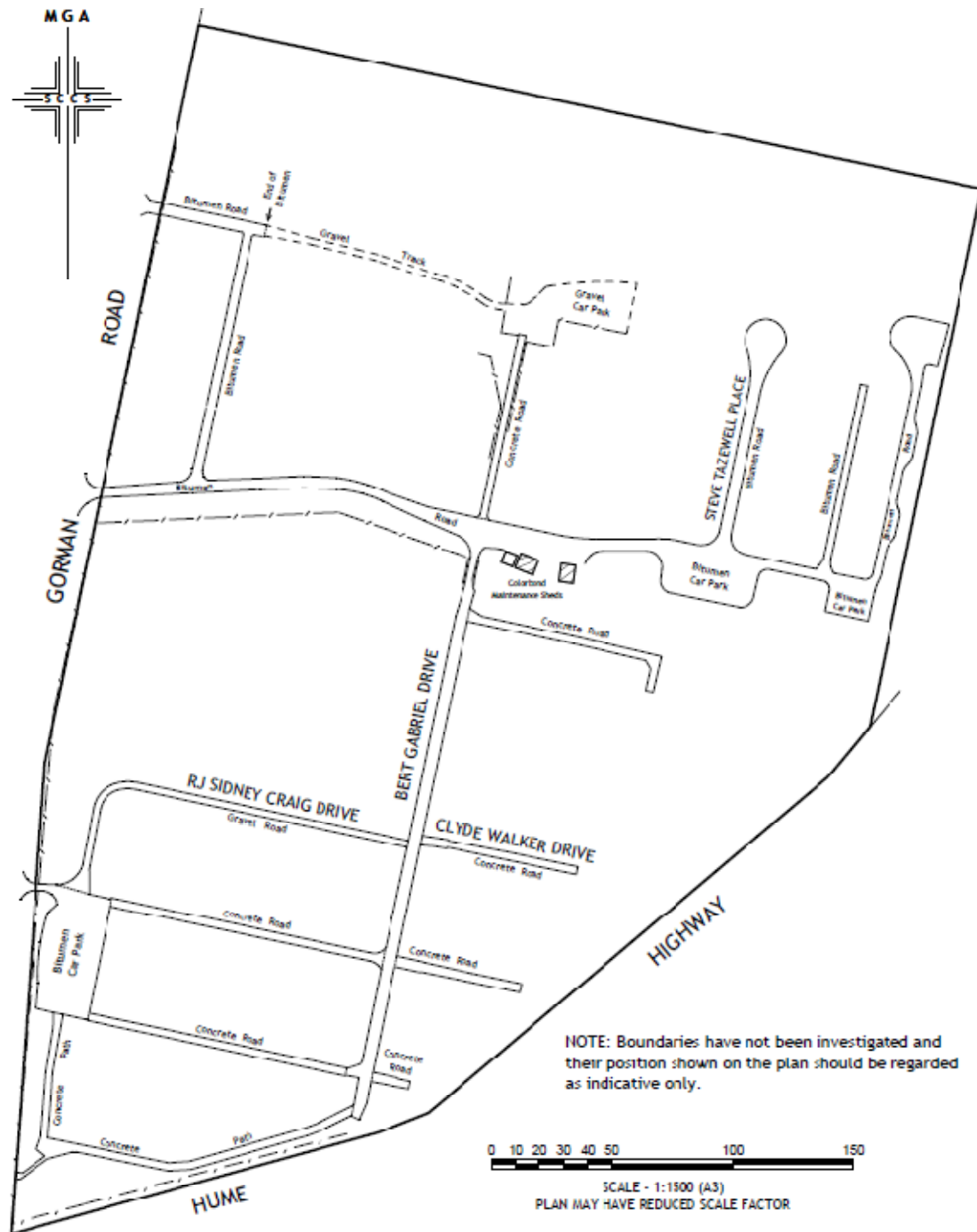

Figure A1-2 – Current Layout

The Goulburn General Cemetery is located in the SP2 Infrastructure Zone as outlined by the 2009 LEP.

## **A1.5 Capacity**

General Cemetery has approximately 4200 surveyed sites with over 2000 surveyed sites reserved. There are currently no unsurveyed sites but there is room for expansion onto some existing sites. Average annual consumption is approximately 150 which include a mixture of ashes and lawn interments. Pre-crematorium lawn interments accounted for approximately 80% of all interments. No data is available to indicate a shift from this figure since the construction of the crematorium. Industry data indicates a shift towards ashes interments will occur.

The capacity of the General cemetery can be greatly increased with the investigation and installation of sites for the interment of ashes.

## **A1.6 Future Memorialisation**

To accommodate future trends in memorialisation, most notably the increased demand for burial by ashes, the following options have been identified as possible areas for expansion.

### **A1.6.1 Ashes Rose Garden**

The area highlighted in Figure A1.3 below to be set aside for the creation of a rose garden that will cater for the interment of ashes. The gardens should consist of named roses that can be used to identify the section of the rose gardens. Space around the rose bushes will be reserved for the interment of ashes, with up to two sets of ashes permitted in one plot.

The area identified is rocky ground with a water easement running through it, which makes it unsuitable for the interment of large coffins. An avenue of trees will be used to screen out the adjoining sections of the cemetery and to assist in making the roses stand out during their flowering periods. Figure A1.4 below is an example

taken from another Cemetery that uses rose gardens with a pine backdrop to enhance the area.



Figure A1.3 – Area identified for Ashes Rose Gardens.



Figure A1.4 – A rose garden used to inter ashes (Palmdale Cemetery)

### **A1.6.2 Ashes Memorial Walk**

The section highlighted in figure A1.5 below is to be set aside for the interment of ashes. The ashes are to be interred with a monument along either side of the existing path. The area already has a designated path and a rotunda (figure A1.6) that can be utilised by visitors to this section. Figure A1.7 below is an example of an ashes monument that could be adopted into this area.



Figure A1.5 – Area proposed for Ashes Memorial Walk (left hand side)



Figure A1.6 – Rotunda located in Memorial Ashes Walk.





Figure A1.7 – Ashes Memorial at Macquarie Park, John Michal O'Keefe.

### **A1.6.3 Scatter Gardens**

The introduction of scatter gardens for ashes, where families may decide they want to scatter the remains of family members that have recently departed or those that have retained ashes of departed family members and wish to have them memorialised at the Cemetery. There are numerous areas of natural bush land and several areas unsuitable for interments that could be easily converted into more formal areas for the scattering of ashes. Several such gardens could be designed to cater for differing preferences.

The area designated for this will include a wall where a plaque can be mounted that will include the name, date of birth and date of death. A picture of the layout for the plaques is included in figure A1.8.



Figure A1.8 – Plaque wall for scatter garden, Macquarie Park Cemetery.

#### **A1.6.4 Memorial Tree Avenue**

An area to be set aside for the planting of trees where a family can install a plaque in spaces allocated next to a tree that will enable a person a place to remember a family member or friend that has not been interred at the Cemetery. The area either side of the Lychgate could be used for this, whereby an effective avenue of trees could be planted to replace the existing avenue of trees that have both reached the end of their life expectancy and add no real aesthetic value to the cemetery. Figure A1.9 below illustrates the area highlighted for this.



Figure A1.9 – Memorial Tree Avenue

### 1.6.5 Family Ashes Gardens

An area on the western side of the cemetery has been set aside for the development of family ashes plots, whereby a family can reserve a garden area for the exclusive use within their immediate or extended families. The burial plots would be used for the interment of ashes only. Figure A1.10 below identifies the area reserved for family ashes gardens, with Figure A1.11 showing an existing garden.



Figure A1.10 – Area for Family Rose Garden (Western Side of General Cemetery)



Figure A1.11 – Example of a Family Ashes Garden

### A1.7 General Cemetery Action Plan

The table below identifies actions that need to be considered in the future development of the General Cemetery.

Issue	Explanation	Possible Response
<b>Signage</b>	Adopt signage in accordance with recommended actions in section 1.	<p>Medium Priority – standardise signs, put in new signs as appropriate, remove and replace obtrusive signs.</p> <p>Signage could also be utilised to assist in educational and cultural tours by providing history of the site and identifying significant graves and monuments within the cemetery.</p>

<b>Ashes Interments</b>	<p>To provide a greater variety of options for the interment of ashes.</p> <p>To accommodate potential development of a local crematorium.</p>	<p>High Priority – provide options highlighted in section A1.6, with the Ashes Rose Garden being the highest priority.</p>
<b>Lawn and Monument Interments</b>	<p>To continue to provide lawn and monument options for memorialisation.</p>	<p>Medium Priority – Expansion into unused areas as demand requires.</p>
<b>Landscaping</b>	<p>To improve the landscaping to allow for a more private and peaceful place for reflection and time with departed family members and friends.</p>	<p>Medium Priority – To enhance the landscape through the use of gardens that can be also utilised for interments of ashes and the placement of effective plantings that can provide privacy for visitors.</p> <p>The installation of structures such as seating and shade areas (rotundas) could be installed in areas adjacent to designated graves.</p>
<b>Security – Fences and Gates</b>	<p>To provide adequate fencing and security to protect against anti-social behaviour after dark.</p>	<p>Medium Priority – the installation of security fencing around the boundary of the cemetery that is in keeping with the aesthetics of the cemetery.</p> <p>The possibility of installing gates and locking gates at dark.</p>

<b>Irrigation</b>	To provide an adequate water supply for maintenance of turf and gardens within the cemetery.	Medium Priority – the investigation of alternate water supplies to water the turf and gardens within the cemetery. A possible source could be the maturation ponds towards the western end of Gorman Road.  The benefits would be improvements to the quality of the turf and appearance of the cemetery as a whole.
<b>Lychgate Restoration</b>	The restoration of a significant monument within the cemetery.	Medium Priority – to source funding to upgrade the Lychgate to its original state.

# Appendix Two – Kenmore Cemetery

## A2.1 Location

The Kenmore Cemetery fronts Middle Arm Road, Goulburn opposite the Mary's Mount Road intersection, refer to Figure A2.1 below – locality plan. The site has an area of approximately 5.7ha. The cemetery was previously known as St. Patrick's Cemetery. The Cemetery is divided into three sections with the land containing the crematorium not owned by the Council.

The surrounding land uses are effectively rural in character and are not owned by the Council. Residential developments have occurred in Amaroo Place and the area off Mary's Mount Road. The Mulwaree High School Agricultural Farm/environment ground is opposite the cemetery along with an Essential Energy substation. Behind the Cemetery is a Council owned recreation reserve, but this is undeveloped at this stage.



Figure A2.1 – Locality Plan

## A2.2 History

In the 1870's the Roman Catholic diocese of Goulburn flourished under the leadership of the Right Rev. William Lanigan. Bishop Lanigan introduced the School in 1874, the Patrician Brothers in 1886, the Presentation Sisters in 1874, the Brigidines in 1883 and the Passionist Fathers in 1890. The construction of the existing former Cathedral was commenced and completed during his tenure as Bishop.

Bishop Lanigan purchased the land for the cemetery, located on Middle Arm Road, in 1888 and it is assumed the cemetery takes its name from the Christian Brother's St Patricks College which was established in 1874. It is worth noting that Bishop Lanigan studied at St Patrick's College in Thurles.

The Roman Catholic Cemetery is notable for the large number of religious burials in special areas set aside for this purpose. The number of such memorials reflects the importance of Goulburn as a diocesan centre with responsibilities for education and training of religious and the lay population.

In April 1998 the Catholic Church transferred ownership of the cemetery to the former Goulburn City Council (now Goulburn Mulwaree Council) for ongoing management and operation. The Church retained ownership of the Chapel and the immediate surrounding burial ground area. Council renamed the cemetery to Kenmore Cemetery to reflect the change in ownership and its operation as a non-denominational burial ground.

Several headstones commemorate deaths which took place prior to the opening of the St. Patrick's Cemetery for burials, which appears to have taken place in the early 1890's with the land having been purchased in 1888. These include those of three children who all died aged one year or less, namely John Joseph Litherland who died in 1881 (entry 1783); Edward Sheekey, who died in 1882 (entry 1402); and Mary Huggins (entry 1378). The earliest death noted on a headstone in this cemetery is that of John Kelly who died in 1854 at Yass, and is recorded on his wife's headstone.

### **A2.3 Status**

The Kenmore Cemetery is an active cemetery with spaces available for lawn interments. Ashes interments are not available on the Council owned portions of the cemetery.

### **A2.4 Current Layout**

The site of the Kenmore Cemetery is relatively isolated to the northern side of the City of Goulburn. A public reserve borders one section of the cemetery along with roads bordering two sides. The north and eastern sides are adjoin privately owned land, which may be an option for expansion into the future if required.

The Chapel (which has recently been converted into a Crematorium and Chapel facility) is centrally located on the site with the area to the south presently occupied by burial sites and associated monuments. The area is formally laid out on the cartwheel pattern, with a grid layout within each segment. Figure A2.2 below illustrates the current layout of the site.



The formal layout provides a strong defining theme for the undeveloped area north of the Chapel.

The land slopes up from the Middle Arm Road (Western side) towards Craig’s Hill at the rear. Some slope instability has been identified for the lower slopes of Craig’s Hill. The instability of sections within the cemetery will impact the potential depth of interments (the unavailability of second or triple depth interments) and may require further investigation into the alternate styles of interment into these sections, such as ashes interments in the ground or into walls, or the use of landscaped areas incorporating ashes interments, which may aid in the stability of the soil.

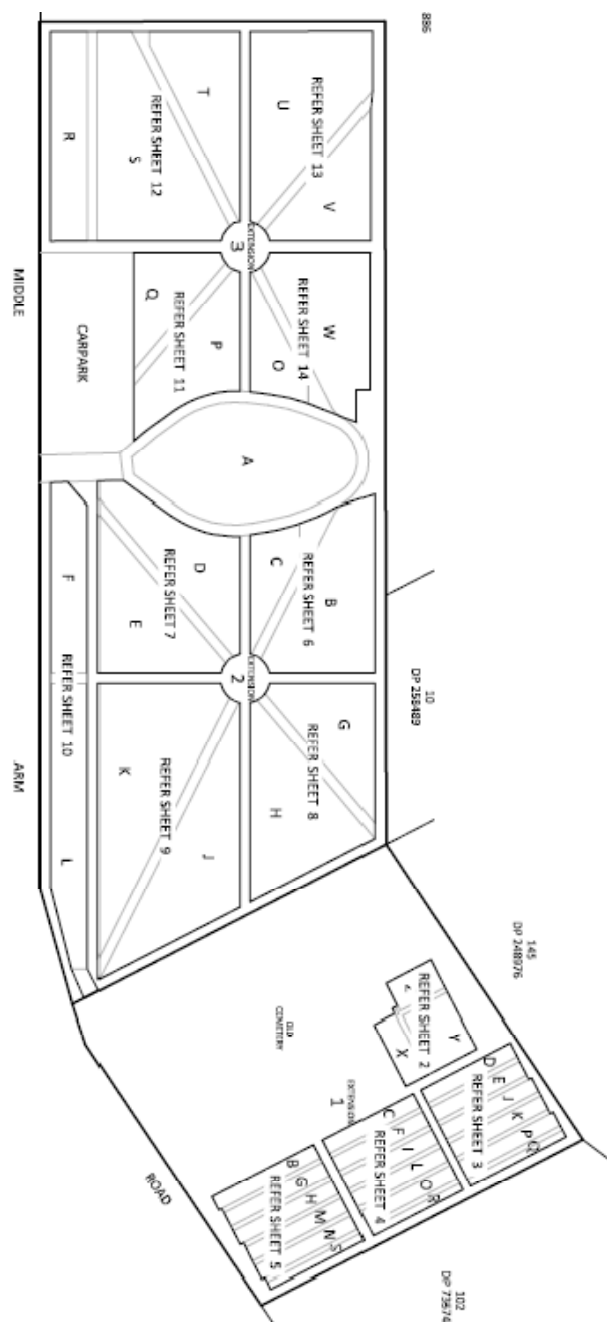

Figure A2.2 – Current Layout

## A2.5 Capacity

Kenmore Cemetery currently has plans to expand to the northern side of the site (Extension 3). Previous figures indicate that there is approximately 6000 unsurveyed sites available for interment, some can cater for double or triple depth interments. There are approximately 2300 surveyed sites with over 1500 of these sites reserved. Current consumption is around 20 interments per year. There is currently no availability for ashes on the Council owned sections of the cemetery.

## A2.6 Future Memorialisation

To address future trends in memorialisation, most notably the increased demand for burial by ashes, the following options have been identified as possible areas for expansion.

### A2.6.1 Memorial Tree Avenue

An area to be set aside for the planting of trees whereby a family can install a plaque in spaces allocated next to a tree that will enable a person a place to remember a family member or friend that has not been interred at the Cemetery. The area to the east of Extension 3 has been identified as a site. The use of trees along this section can also be used to enhance the overall visual impact of the cemetery. An avenue of same species trees is recommended to add to the visual impact. Figure A2.3 below illustrates the area highlighted for this (bordering Extension 3, Portions V and W and along the northern border of the existing site).



Figure A2.3 – Proposed site for memorial Tree Avenue

### **A2.6.2 Ashes Gardens**

The use of the entrance paths into the cemetery bordering Portions P, O and W to create gardens for interment of ashes would assist in defining the border along this road and enhance the visual impact when arriving into the cemetery, along with providing an option for the interment of ashes, which are not currently available on the Council owned portion of the cemetery.

The conversion of Portion R into a garden for the interment of ashes would also aid in not providing a space for this style of memorialisation but aid in screening the cemetery from the road and enhancing the overall aesthetic appeal.

### **A2.6.3 Ashes Walls**

The installation of ashes walls, such as those at the Goulburn General Cemetery, could be provided on the western side of Portion Q. This site would allow for the walls to be incorporated into the existing landscape surrounding the car park. An example of an existing ashes wall used at the General Cemetery is shown in Figure A2.4.



Figure A2.4 – Ashes Walls

### A2.6.4 Infant Section

The provision for a section, within Extension 3, is to be allocated to the interment of infants. A suitable area should be close to the chapel, possibly within Portions O or W.

## 2.7 Kenmore Cemetery Action Plan

The table below identifies actions that need to be considered in the future development of the Kenmore Cemetery site.

<b>Issue</b>	<b>Explanation</b>	<b>Possible Response</b>
<b>Signage</b>	Adopt signage in accordance with recommended actions in section 1.	Medium Priority – standardise signs, put in new signs as appropriate, remove and replace obtrusive signs.  Signage could also be utilised to assist in educational and cultural tours by providing history of the site and identifying significant graves and monuments within the cemetery.
<b>Ashes Interments</b>	To provide a greater variety of options for the interment of ashes.  To accommodate potential increased demand for ashes interments resulting from the development of a local crematorium.	High Priority – provide options highlighted in section A2.6.
<b>Lawn and Monument Interments</b>	To continue to provide lawn and monument options for memorialisation.	Medium Priority – Expansion into unused areas as demand requires.

<b>Infant Section</b>	The provision of a section for the interment of infants within Extension 3.	A designated area allocated for the interment of infants within the cemetery.
<b>Landscaping</b>	To improve the landscaping to allow for a more private and peaceful place for reflection and time with departed family members and friends.	High Priority – the establishment of an avenue of trees that can be utilised as a remembrance grove with spaces provided at the base of each tree for plaques.  Medium Priority – establish shaded landscape features at each hub with visitor seating.  Street tree style plantings along each pathway or ‘spoke’.
<b>Fencing</b>	To provide adequate fencing and entrances into the cemetery.	Medium Priority – the retention of the rural style fencing around the perimeter of the cemetery.  The upgrading of the southern entrance into the cemetery.
<b>Irrigation</b>	To provide an adequate water supply for maintenance of turf and gardens within the cemetery.	Medium Priority – the investigation of alternate water supplies to water the turf and gardens within the cemetery.  The benefits would be improvements to the quality of the turf and appearance of the cemetery as a whole.

<b>Access ways</b>	The upgrading of the paths and access ways throughout the cemetery.	<p>Medium Priority – to seal the access ways throughout the cemetery, to aid in vehicular and pedestrian access to each burial site.</p> <p>Create boulevards along the alignment of each path way (spoke) with street tree style plantings.</p>
<b>Facilities</b>	To provide visitor's with adequate public amenities when visiting the cemetery.	The construction of a public amenity block within the cemetery grounds.

# Appendix Three – Tarago Cemetery

---

## A3.1 Location

The Tarago Cemetery is located in the rural village of Tarago and fronts Lime Street. The cemetery is in a rural setting within a bushland setting, it is on a small rise above the village with views to the East and South.

The cemetery is divided into two parts, Anglican and Catholic, and covers an area of approximately 5600m<sup>2</sup>. Figure A3.1 below shows the locality of the Tarago Cemetery.

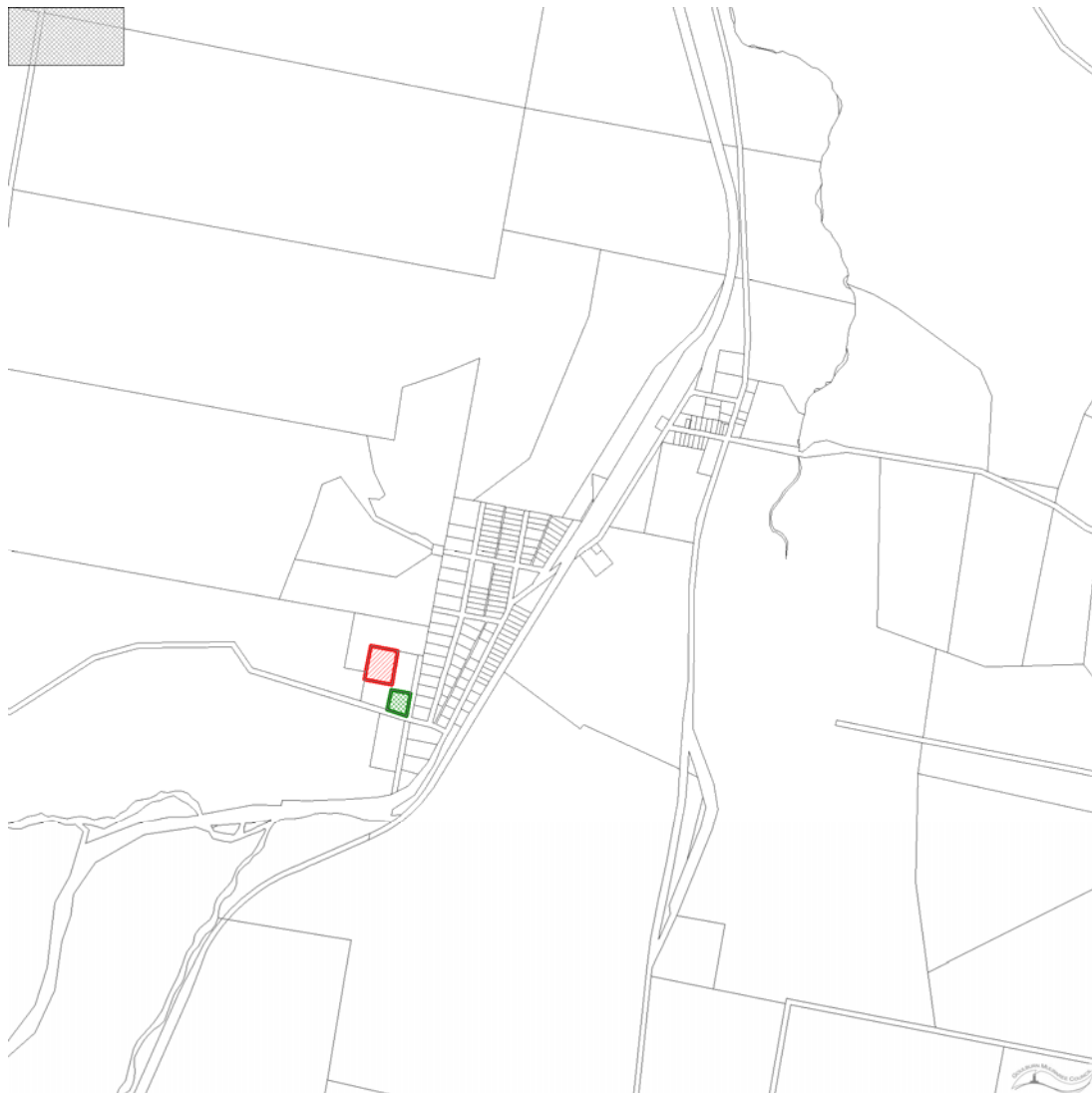

Figure A3.1 – Locality Plan

### **A3.2 History**

The Tarago Cemetery is in two parts, the Anglican (Church of England) section being the northern part and the Catholic section being the southern part of the cemetery.

The Anglican section was consecrated on the 31<sup>st</sup> August 1924 the trustees of this section are the Anglican Property Trust. One of the earliest recorded burials is for a Mrs. Eliza Welch, 18<sup>th</sup> March 1927, aged 77 ½ years.

The Catholic section is situated on the western side of the Tarago to Bungendore Road, 1 kilometre south of the village of Tarago (as transcribed by Stuart Anderson, 24<sup>th</sup> March 1986). One of the oldest recorded graves on this site is for a Mrs Jayne Byrne who died on the 5<sup>th</sup> August 1888.

There are several war graves located in the Tarago Cemetery, including L/Corporal Harold Lehane killed in action in France 17/8/1916, William P Tynan killed in France 4/8/1916 aged 24years and 5months. Pte. F.M. Gann killed in action on the Somme, France 24/10/1916 aged 24 years.

Both sections of this cemetery are listed on the web site <http://www.gundaroo.info/genealogy/cemeteries/tarago/taragob.gif> which provides information as to who is buried within the cemetery grounds, and as to when they where buried.

### **A3.3 Status**

The Tarago Cemetery is an active cemetery with spaces available for both lawn interments and ashes interments.

### **A3.4 Current Layout**

The current layout for the Catholic section of the cemetery is rectangular blocks of 16 graves, being 2.44m x 1.22m, the blocks are designated by the letters 'A' through to 'K', Figure A3.2 and A3.3 outline the current layout for both the Catholic and Anglican sections of the cemetery.

The current layout for the Anglican (Church of England) section of the cemetery is in two parts , the first with blocks of graves of mainly 24 in each block, being 2.44m x 1.22m and designated by the letters 'A' through to 'H'. The second part are blocks of 23 graves the same dimensions as the first part designated by the letters 'A' through 'H'.



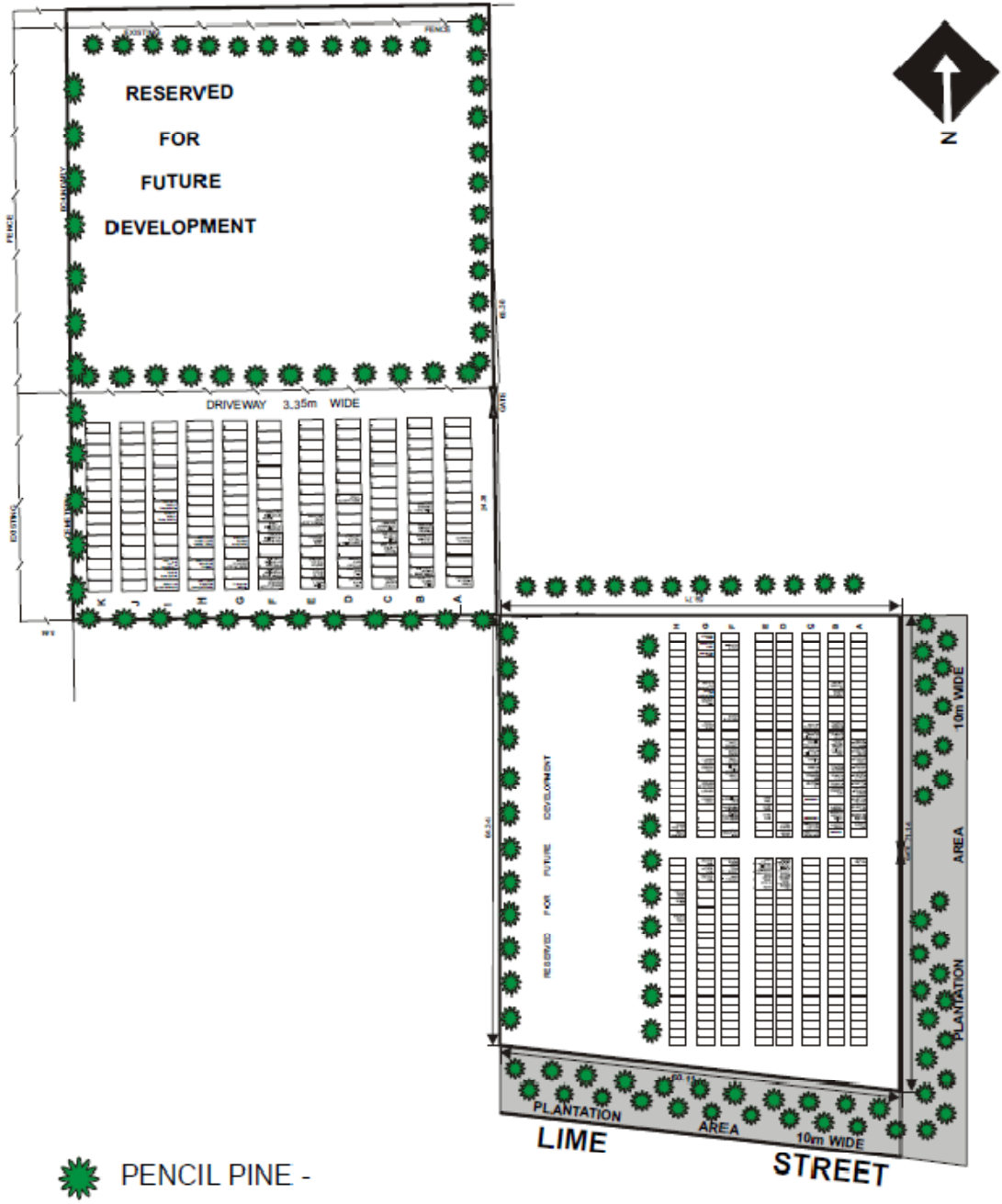

Figure A3.2 – Layout and proposed tree layout



Figure A3.3 – Overhead layout of Tarago Cemetery

### A5.5 Capacity

Tarago's current usage is approximately 1 grave per year. There is approximately:

- Anglican Cemetery 384 graves, of which approximately 90 are used or reserved; and
- Catholic Cemetery 176 graves, of which approximately 38 are used or reserved.

## A5.6 Action Plan

The table below identifies actions that need to be considered in the future development of the Tarago Cemetery site.

<b>Issue</b>	<b>Explanation</b>	<b>Possible Response</b>
<b>Fencing</b>	Update existing fencing.	Retain post and wire rural style fencing around the perimeter of the cemetery.
<b>Landscaping</b>	To establish a more formal style of tree planting around the perimeter of the cemetery.	Establish a formal avenue of trees around the perimeter of the two sites that would give the cemetery a pioneer feel and once established would provide green foliage all year round. Pencil pines would be an ideal species.
<b>Layout</b>	To provide for expansion, as required.	Replicate the existing layout into future expansion of the site.  Provide additional areas for interment of ashes.
<b>Signage</b>	Adopt signage in accordance with recommended actions in section 1.	Standardise signs, put in place new signs as appropriate, remove and replace obtrusive signs.

# Appendix Four – Tallong Cemetery

## A4.1 Location

The site of the Tallong Cemetery has long been established approx 2.5 km to the east of the village of Tallong, it is surrounded by rural activities, and the site has a 75% cover of native vegetation. The Council currently works with local and regional groups to preserve identified native vegetation within the grounds.

The Tallong Cemetery is located East of the rural village of Tallong and fronts Long Point Road.

The property description is 1020-3040 with an area of approx. 25,000m<sup>2</sup> (see Figure A4.1 – **LOCALITY**).



Figure A4.1 – Locality

## A4.2 History

The Tallong Cemetery, the oldest burial appears to be that of Albert Edward Hoare on the 20<sup>th</sup> March 1910. Prior to this it seems that burials may have taken place at the old Marulan Cemetery.

On the 5<sup>th</sup> January 1957, a report in the Goulburn Evening Post reported two men and two boys drowned near Badgery's Lookout on the Shoalhaven River at Tallong. One of the boys got into trouble and his brother went to assist him, and two men went bravely to attempt rescues, but all drowned. Those drowned were Hilary Rumsey 47 orchardist, Tallong. Victor Luke 40 a builder of Newbury Park, Penrose, and both Hilary Rumsey's sons Michael aged 12 and Bruce aged 10. All drowned at a section of the river locally known as "Broken Rock" It was Michael Rumsey's birthday.

Military graves: N75995 Sergeant A.L. Hunt Army Medical Corps died on 25 Jun 1951 aged 60. 4544 CW Burrows 53<sup>rd</sup> Batt. Died 17<sup>th</sup> October 1943 aged 71 (Military Insignia)



Figure A4.2 – Rumsey and Luke grave site.



4544 **CW BURROWS** 53rd Batt.  
Died October 1943 age 71



N75995 **Sergeant AL HUNT**  
Army Medical Corps  
Died on 25th June 1951 age 60



1099 Private  
**FREDERICK ROBERT WEIR**  
14th Field Ambulance  
Died 2nd July 1924

At enlistment: occupation station hand.  
next of kin: Father GS Weir of Thomas St Croydon, South Aust.  
Religion Church of England enrolled 14/9/1914

### **A4.3 Status**

The Tallong Cemetery is an active cemetery with spaces available for both lawn interments and ashes interments.

### **A4.4 Current Layout**

The Tallong Cemetery is laid out in a grid like pattern, consisting of 15 rows numbered 'A' to 'O' with 72 graves per row, divided in half with a walkway in the middle. An ashes wall is located on the Eastern side of the cemetery.

Figure A4.3 below illustrated the current layout of the cemetery.

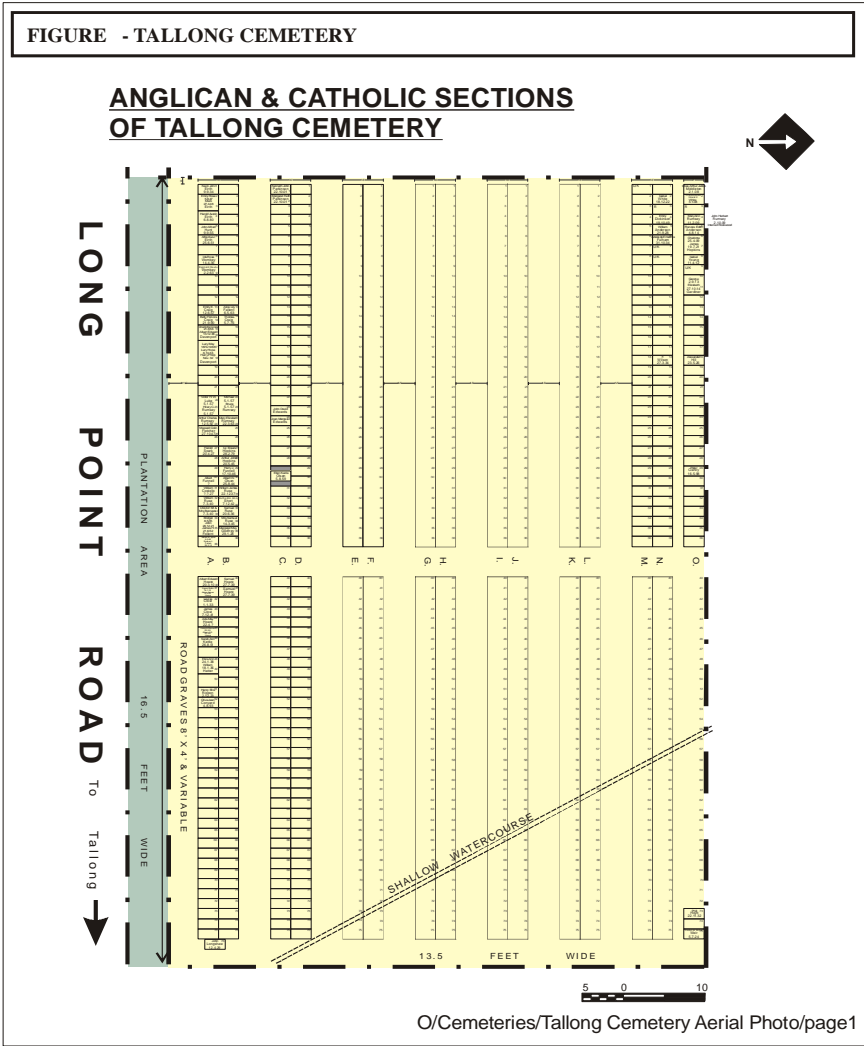

Figure A4.3 – Current Layout.

**A4.5 Capacity**

There is space for 1080 graves within the Tallong Cemetery, including space for ashes interments.

## A4.7 General Action Plan

<b>Issue</b>	<b>Explanation</b>	<b>Possible Response</b>
<b>Signage</b>	Adopt signage in accordance with recommended actions in section 1.	Standardise signs, put in place new signs as appropriate, remove and replace obtrusive signs.
<b>Layout</b>	Retention of the heritage layout and feel for the cemetery.	Maintain the heritage layout of the cemetery.
<b>Landscaping</b>	Retain heritage feel of the cemetery and enhance when possible.	Continue maintenance of existing landscape.



# Appendix Five – Jewish Cemetery

## A5.1 Location

The Jewish Cemetery fronts Long Street, Goulburn (refer to Figure A5.1 – Locality Plan below). The site has an area of approximately 2000m<sup>2</sup>.

Title for the cemetery does not sit with Council.

The surrounding land is subject to development pressures. The land immediately surrounding the cemetery is proposed to be industrial. To the west of the cemetery there is a proposal for residential as there are no plans to extend the cemetery.

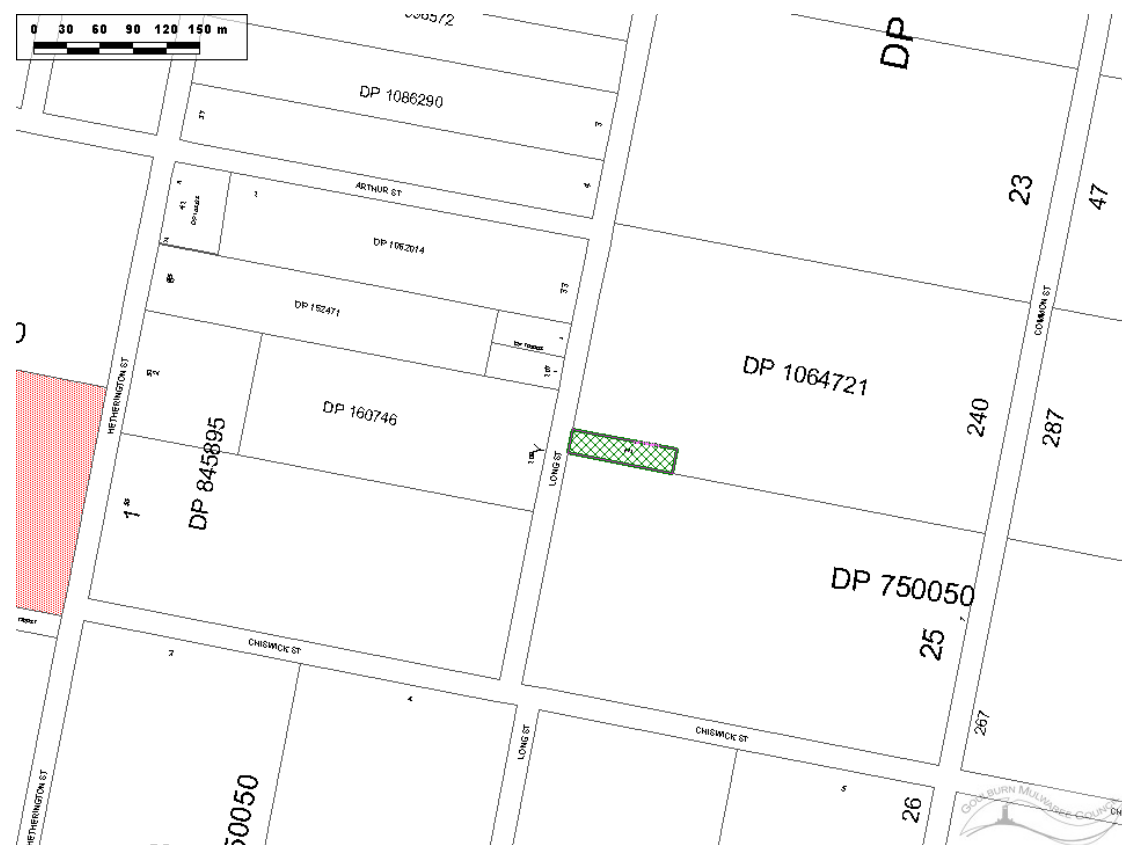

Figure A5.1 – Locality Plan

## A5.2 History

The first mention of the Jewish Cemetery is made in a London based Jewish Newsletter “The Voice of Jacob” in 1844 where it is stated that Messrs Benjamin and Moses had agreed to dedicate an acre of ground for a Jewish Cemetery. Most of the surrounding twenty acre blocks of farmland were owned by the Jewish community, who from the 1840’s to the 1870’s were numerous and important.

Goulburn had the third largest Jewish community in New South Wales but over time the Jewish population has sharply declined to a point that there are no more burials taking place within the cemetery.

The first burials were in November 1844, reported in the Sydney Morning Herald 28<sup>th</sup> November 1844; where two sisters, Sarah and Hannah Moses, drowned when their father attempted to cross the river at Yass.

In February 1845 the combined store and inn of Issac Davis was held up by a number of armed and masked men, Mr Davis was shot dead by one of the gang; he is buried at the Jewish Cemetery.

Mrs Rebecca Moses, the wife of John Moses, who “departed this life on January 8<sup>th</sup> 1851”, was the first Jewish woman who married in Australia. The remains of the caretaker’s cottage that was built in 1848 can still be seen (refer to Figure A2.2 – Advertising Info Pamphlet, below, for further information on cottage).

‘As at 14 Oct 2005 there were 87 marked graves and another 27 names on unmarked graves, I walked and wrote down all existing markers and headstones on 21 Sep 2005’ (Barry Stephenson).

The Jewish Cemetery has been placed on the National Trust of Australia (New South Wales) register. The register includes those buildings, sites and areas which in the Trust’s opinion, fall within the following definition:

*“Those places which are components of the natural or the cultural environment of Australia, that have aesthetic, historic, scientific or social significance or other special value for future generations, as well as for the present.”*

## GOULBURN JEWISH CEMETERY (BURIAL GROUND) Long Street



*Goulburn Jewish Cemetery caretakers cottage built in 1848, only the ruins remain.*

In 1844 the first mention of the Jewish Cemetery is made in a newsletter "The Voice of Jacob", it states that Messrs. Benjamin and Moses had agreed to dedicate an acre of ground for the cemetery. Later the official measurements are given as 312 feet by 71 feet and an "area of approx 22 perches"

The first burials in the cemetery were in November 1844 when after an accident in Yass, two sisters were drowned when their father attempted to cross a flooded crossing. The girls, Sarah & Hannah Moses were brought to Goulburn for burial, their graves are unmarked.

## GOULBURN JEWISH CEMETERY (BURIAL GROUND) Long Street



Mrs Rebecca Moses, the wife of John Moses who departed this life on January 8th 1851 aged 46 years, she was the first Jewish woman married in Australia

*Historic headstone  
Mrs Rebecca Moses*

HENRY ISAACS CARO	Died 11th September 1877
LYDIA COLLINS	Wife of Joseph COLLINS died 15th March 1862 aged 80? years "died on the Holy Sabbath Day"
ISAACS DAVIS	Died 9th February 1845 aged 33 years
MARK DAVIS	Mark Elgin, youngest son of David & Rachael DAVIS, died 24th June 1860 aged 12 months?
HUGO GOLDBERGER	Died ...1943 aged 65 years
LOUIS MANDELSON	"our husband and father died 17...9
LOUIS MANDELSON	second son of E. & C. MANDELSON, died 12th December 1863 aged 18 months
MOSES MARKS	died 5th August, 1869 aged 70? years Masonic symbol on headstone.
REBECCA MOSES	wife of John MOSES died 8th January 1854 aged 46 years
SIEGFRIED VOGEL	died 9th October 1943 aged 56 years
SALL YAVIS Esq.	Solicitor, late of London, died 6th July ... aged 79 years.
UNKNOWN	.....died 16th April .....aged 53 years

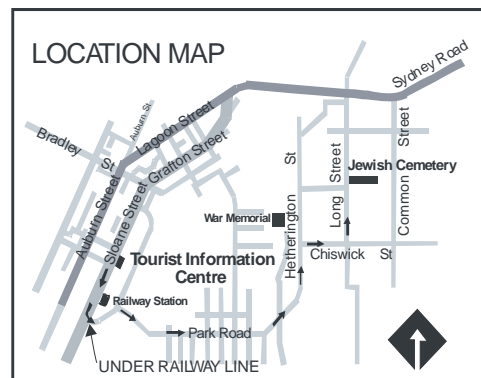

PRODUCED BY GOULBURN MULWARRIE COUNCIL

### CEMETERYS/JEWISH PAMPHLET

Figure A2.2 – Jewish Cemetery Pamphlet

### A5.3 Status

The Jewish Cemetery is not active.

## A5.4 Current Layout

From an aerial photograph perspective there does not appear to be a layout design. At ground level there is a layout. Figure A5.3 below shows an aerial photograph of the site, whilst A5.4 illustrates the layout from ground level. Figure A5.5 (below) is a Landscape Plan for the site.



Figure A5.3 – Aerial Photograph of Layout



Photograph A5.4 – Jewish Cemetery

# JEWISH CEMETERY (BURIAL GROUND)



"The English - Voice of Jacob, of the 6/6/1845 said:  
 At Gouburn, an inland town 170 miles to the southward,  
 services were performed at the residence of Mr. Elias Moses,  
 who has recently given an acre of land for a Jewish Cemetery".

HENRY ISAACS CARO	Died 11th September 1877
LYDIA COLLINS	Wife of Joseph COLLINS died 15th March 1862 aged 80? years "died on the Holy Sabbath Day"
ISAC DAVIS	Died 9th February 1845 aged 33 years
MARK DAVIS	Mark Elgin, youngest son of David & Rachael DAVIS, died 24th June 1880 aged 12 months?
HUGO GOLDBERGER	Died ..... 1943 aged 65 years
LOUIS MANDELSON	"our husband and father, died 17.....9
LOUIS MANDELSON	second son of E. & C. MANDELSON, died 12th December 1863 aged 18 months.
MOSS MARKS	died 9th August, 1869 aged 70? years Masonic symbol on headstone
REBECCA MOSES	wife of John MOSES died 8th January 1854 aged 46 years
SIEGFRIED VOGEL	died 9th October 1943 aged 56 years
SAUL YATES Esq	Solicitor, late of London, died 6th July ..... aged 79 years.
UNKNOWN	..... died 16th April ..... aged 53 years

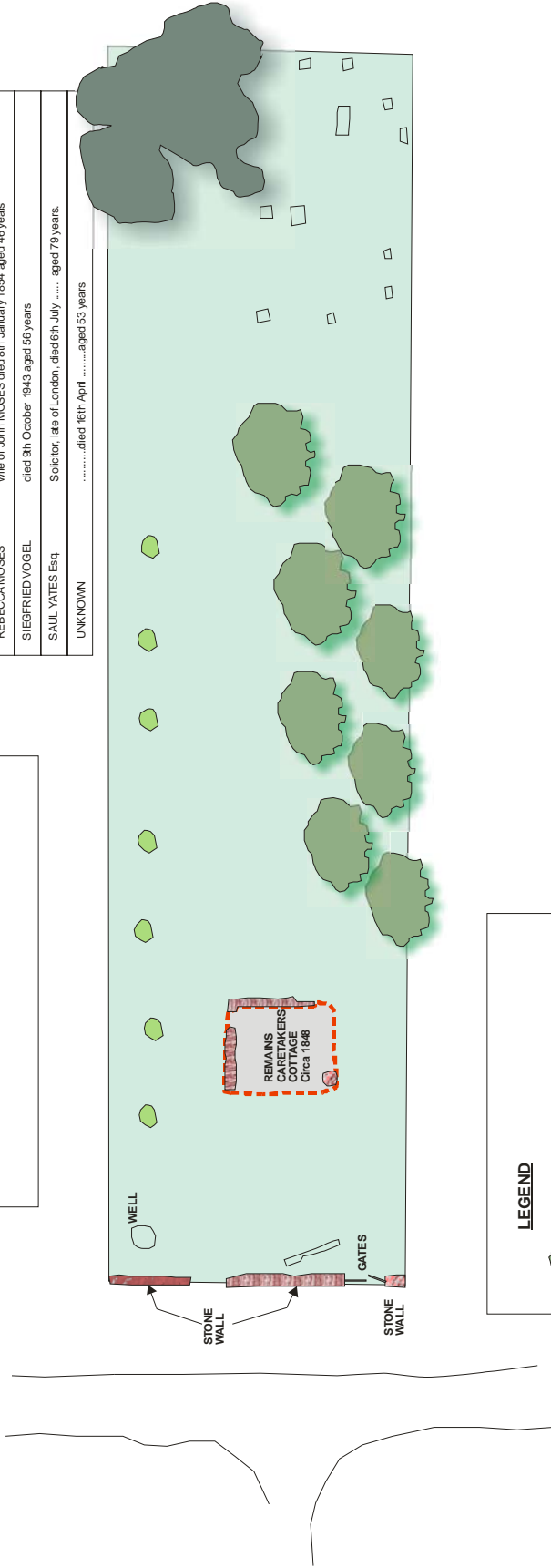

**LEGEND**

- GOLDEN CYPRESS C. *leylandii* "Castelwellan Gold"
- PINK FLOWERING IRON BARKS *E. sideroxylon* "Pink"
- GREEN WATTLES *A. decurrens*

REVISIONS	APPROVED	GOULBURN MULVAREE COUNCIL	TITLE NO.	NO. OF SHEETS
SCALE 1:200	SPECTORNS	THE JEWISH CEMETERY LONG STREET	1	1
			DRAWN BY: J. MULVAREE	
			DATE: 10/10/2017	

Figure A5.55 – Landscape Plan of Jewish Cemetery.

## A5.5 Capacity

Not applicable as this site is not active.

## A5.6 Jewish Cemetery Action Plan

Issue	Explanation	Possible Response
<b>Signage</b>	Adopt signage in accordance with recommended actions in section 1.  All signs within the cemetery to be in accordance with Jewish heritage.	Standardise signs, put in place new signs as appropriate, remove and replace obtrusive signs.
<b>Layout</b>	Retention of the heritage layout and feel for the cemetery.	Maintain the heritage layout of the cemetery.
<b>Landscaping</b>	Retain heritage feel of the cemetery and enhance when possible.	Continue maintenance of existing landscape.

# Appendix Six – Mortis Street Cemetery

---

## A6.1 Location

The Mortis Street Cemetery is located in north Goulburn and is divided into three sections, with two being owned by the State of New South Wales (Crown Land) and managed by the Goulburn Mulwaree Council, and the third section owned by the Uniting Church (refer to Figure A6.1 and A6.2 below):

- Crown Land managed by Goulburn Mulwaree Council:
  - Methodist Section – Lot 7061, DP 96847;
  - Catholic Section – Lot 7062, DP 96847
- Land owned by the Uniting Church:
  - Presbyterian Section – Lot 1 DP 782646



Figure A6.1 – Aerial view of Mortis Street Cemetery.



Figure A6.2 – Location of Mortis Street Cemetery

## A6.2 History

Goulburn's first cemetery was St Saviour's, Church of England burial ground, located on the north-eastern fringe of the town. This cemetery was in use from c.1830 to 1937. The Mortis Street Cemetery was subsequently established by the combination of the other three burial grounds; the Presbyterian section which was gazetted on 18<sup>th</sup> May 1843; the Catholic section gazetted on 21<sup>st</sup> March 1846 and the Wesleyan/Methodist section on 30<sup>th</sup> January 1850.

However the earliest burials date to c.1832 and these were predominately in the Catholic section. By 1858 in a population numbering 7028 in the electorates of Argyle and Goulburn, 2622 of the inhabitants were Catholics, out-numbered by Church of England adherents by only 504. In 1903, the new Goulburn General Cemetery located on the slope of Governor's Hill was dedicated and opened.

The Mortis Street Cemetery was then formally closed, c.1903, and since that time, the management of the Cemetery has been an ongoing issue. In October 1967 Goulburn Council accepted the responsibility of Trustees, with the care, control and management of the Cemetery. In 1969 there was a proposal to convert the Cemetery into an area for 'passive recreation'. This proposal was deferred until the matter was again raised, almost a decade later, at a public meeting in 1978. Again, no decision was made. Objections to the proposal were received by Council, including a petition signed by 64 residents. In July 1978, the Council resolved to lease the Cemetery and committed to maintain the area. By 1979, there was a commitment to its preservation as a 19<sup>th</sup> century 'Pioneer Cemetery'.



Charles Rogers (1844-1909), cabinet maker and merchant, was born on 18<sup>th</sup> November 1844 at 17 Sweet Apple Court, Hackney Road, Middlesex, London, son of Charles Rogers (1805-1864), furniture maker, and his wife Margaret, née Edmundson (1812-1870). After some elementary schooling he began training as a cabinet maker. About 1859 Rogers arrived in Australia with his family. They settled at Goulburn, New South Wales, where his father set up a small cabinet-making business and Charles continued to learn his trade. On 8<sup>th</sup> March 1866 he married Elizabeth Johnston, daughter of a veterinary surgeon; she died suddenly on 26<sup>th</sup> March 1877. On 12<sup>th</sup> April 1878 at Newtown he married Agnes Hair.

Rogers prospered and the cabinet-making factory employed thirty workers. He had his own network of horse-drawn vans to supply furniture to his agents dispersed from Cooma to Wagga Wagga. Also a retailer and importer, he established a sixty-horse coach line between Goulburn and Yass and ran a livery stable. A great lover of horses, he took pride in driving his own four-in-hand and enjoyed the good things of life.

In 1879 he moved into new premises known as the Goulburn Arcade in Auburn Street, designed and built under his own meticulous supervision, and there he became the 'universal provider'. The reputed value of the building, site and stock-in-trade was £90,000. From 1885 his business enterprises expanded south with the railway.

Liberal and public spirited, Rogers helped all charities and religions. A Methodist, he became a trustee of North Goulburn Methodist Church in 1884, and a magistrate next year. He often criticized the local council and others where the interests of Goulburn and his own business were concerned. In the 1880s he led a deputation to the secretary for public works on the vexed question of differential railway freight rates. In 1908 he was president of the local branch of the Rating on Unimproved Values League.

Rogers visited England and made other sea voyages. In March 1900 in the *Yass Evening Tribune* he published a twenty-five chapter description of his tour to the Western Pacific islands. Rogers died of cirrhosis of the liver at Colombo, Ceylon, on 17 May 1909 while on a cruise and he was buried in the Ceylon general cemetery.

His body was reinterred in the Methodist section of the Mortis Street cemetery on 10<sup>th</sup> October 1909. He was survived by two sons and two daughters of his first wife, by his second wife and their three sons, who conditionally inherited his business and estate valued for probate at almost £35,000. They traded as Charles Rogers & Co. until 1947 when the department store was sold to Burns Philp & Co. Ltd.



Figure A6.3 – The Roger’s monument in the Mortis Street Cemetery.

### **A6.3 Status**

Mortis Street Cemetery is not active.

### **A6.4 Current Layout**

The layout of the cemetery is in three sections, as outlined in A6.1 Location. The layout of the graves appears to be a classic grid layout, with the use of monuments to depict the graves. The age of the graves is starting to become evident with several graves requiring monitoring and evaluation of current stability.

## A6.5 General Action Plan

Issue	Explanation	Possible Response
<b>Signage</b>	Adopt signage in accordance with recommended actions in section 1.	Standardise signs, put in place new signs as appropriate, remove and replace obtrusive signs.
<b>Layout</b>	Retention of the heritage layout and feel for the cemetery.	Maintain the heritage layout of the cemetery.
<b>Landscaping</b>	Retain heritage feel of the cemetery and enhance when possible.	Continue maintenance of existing landscape.
<b>Significant Graves</b>	To retain heritage graves of historical significance and maintain the safety of the site.	<p>To work with families (grantees) to source funding through grants to retain historically significant graves.</p> <p>To make graves safe if stability of structures poses a threat to visitor health and safety.</p>

# Appendix Seven – Other Cemeteries

The table below lists the cemeteries, within the Goulburn Mulwaree Council Local Government Area, that are not managed by Council.

CEMETERY	ACTIVE
St. Saviour's Cemetery	No
Tirrannaville Church of England General Cemetery	Yes
St John the Evangelist Cemetery Towrang	Yes
Yarra and Norong, Catholic, 8km North of Towrang near Greenwich Park Rd	Yes
St. Mark's Anglican Church Cemetery "Bronte" private cemetery, near Windellama	Yes
St Laurence Roman Catholic church cemetery Spring Valley	Yes
"The Forest" Middle Arm Rd, Anglican Church Cemetery, Ryanna	Yes
St Patrick's College Cemetery (Set aside for the burial of Christian Brothers and priests associated with college)	Yes
St Patricks Cemetery Middle Arm Rd (set aside for the burial of Nuns and Priests of the Catholic Church)	Yes
Yarra Anglican Church Cemetery	Yes
St Bartholomew Church Cemetery Windellama	Yes
Bullamalita Private, Bullamalita property 21km south of Goulburn	Private
Joppa, private property between Hume Hwy near Run-O-Waters	Private
Tirranaville private, Gibson property on Braidwood Road	Private
Windellama Catholic Cemetery, private property, 3kms southwest of Windellama	Private
Merilla Uniting Church, Gurrundah Road	Yes
Ryansvale Catholic Cemetery, Springfield property	Private
Tarlo Catholic Cemetery, private property, Taralga Road	Private
Brayton Church of England, Bullpit Rd	Yes
Bungonia, "Brisbane Meadow", private property, 1 grave	Private
Bungonia Catholic, Windellama Road	Yes
Bungonia Anglican, Windellama Road	Yes

Towrang Church of England, situated in village of Towrang	Yes
Komungla Siding Road (Bangalore) General Cemetery near Springfield	Yes
St Johns Anglican Church Cemetery Lake Bathurst	Yes
Marulan Roman Church Cemetery	Yes
Marulan Church of England Cemetery	Yes
Mummel Cemetery	Yes
Parkesbourne Uniting Church Cemetery	Yes
St James Anglican cemetery Kippilaw	Yes
Lumley Road Cemetery	Private
Granger Road, (Rose Lagoon)	Private